

Worall

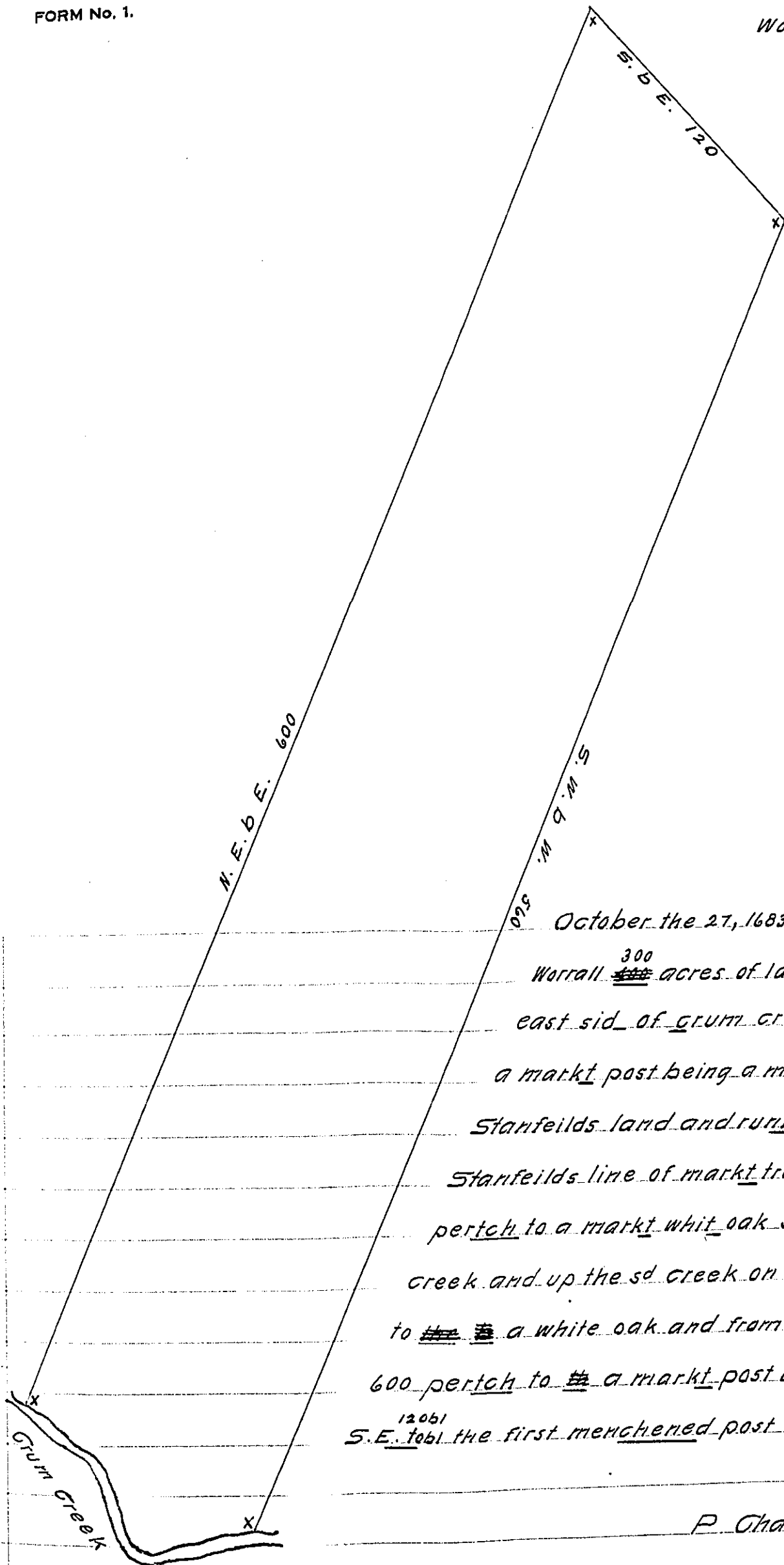

October the 27, 1683 surveyed for Peter  
 Worall <sup>300</sup> ~~400~~ acres of land lying on the  
 east sid of crum creek begining at  
 a markt post being a mark of foblan cis  
 Stanfeilds land and runing along the sd  
 Stanfeilds line of markt trees s.w.b.w. 560  
 pertch to a markt whit oak standing by crum  
 creek and up the sd creek on severall courses  
 to ~~the~~ ~~a~~ a white oak and from thence N.E.b.E  
 600 pertch to ~~the~~ a markt post and from thence  
 S.E. <sup>1200</sup> to ~~the~~ the first menched post

P. Charles Ashcom

IN TESTIMONY that the above is a copy of the original remaining on file in  
 the Department of Internal Affairs of Pennsylvania, made  
 conformably to an Act of Assembly approved the 16th day of  
 February, 1833, I have hereunto set my Hand and caused  
 the Seal of said Department to be affixed at Harrisburg,  
 this twenty sixth day of June 1909

*Nancy Howell*  
 Secretary of Internal Affairs.